

RoHS Compliant

REV.NO.	REVISED	DATE	DRAWN	CHECKED	APPROVED
0	NEW DRAW	00.11.22	WJ.KIM		
1	APPROVAL DRAWING	01.01.04	WJ.KIM		
2	Film type CHANGE Clear → Anti-Glare	01.03.26	WJ.KIM		

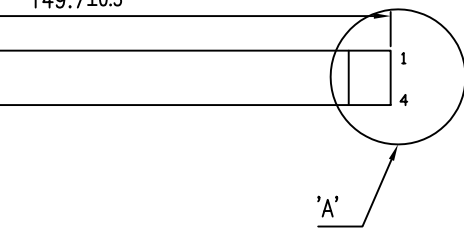
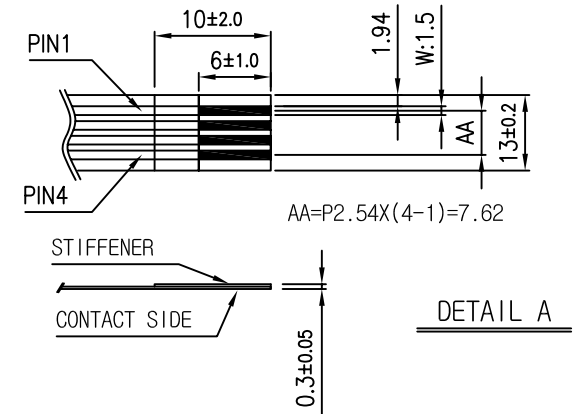
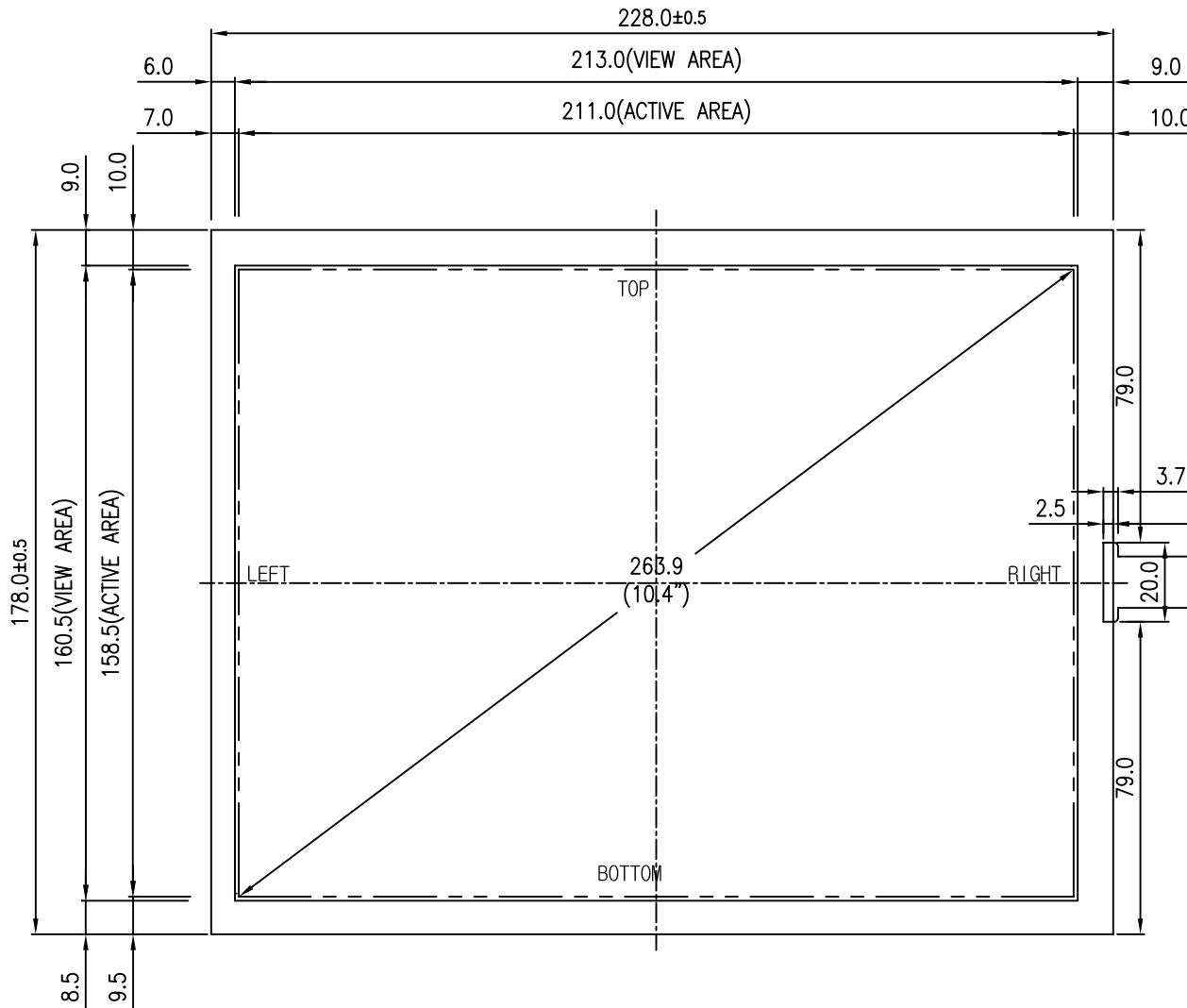

NOTE

- 1) TYPE : ANTI-GLARE TYPE
- 2) GLASS THICKNESS : 1.8t
- 3) FILM THICKNESS : 175/188 ±10_{μm}
- 4) CONNECTOR : FPC
- 5) GENERAL TOLERANCE : ±0.2



TERMINAL	
NO	SYMBOL
1	LEFT
2	TOP
3	RIGHT
4	BOTTOM

10.4" TOUCH PANEL

SCALE : NONE

NOTE: The HantouchUSA Incoming Inspection Standard is part of this drawing. This quality and performance document can be viewed at: www.hantouchUSA.com, under Incoming Inspection Standards.

APPROVE		UNIT	mm	PROJECTION	DRAWING NO.	REV.
CHECK		SCALE	NONE		H4104A-NENBS52	
DESIGN		Han touch USA			DESCRIPTION	SHEET
DRAW		Touch Screen Specialists			10.4" TOUCH PANEL	1/1